

NWL0001690385D
6/25



GoMax™
INFANT CAR SEAT BASE

Read This Instruction Manual

Do not install or use this child restraint until you read and understand the instructions in this manual.

**FAILURE TO PROPERLY
USE THIS
CHILD RESTRAINT
INCREASES THE
RISK OF SERIOUS
INJURY OR DEATH IN
A SUDDEN STOP OR
CRASH.**

**KEEP INSTRUCTIONS
FOR FUTURE USE.**

www.gracobaby.com

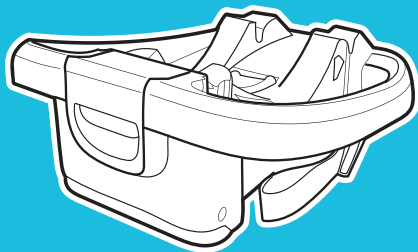

Important

Pages 4-9

- 1-A Welcome to the Graco Family!**
- 1-B Safety Warnings**
- 1-C Aircraft Installation**

Features

Pages 10-13

- 2-A Car Seat Base Features**
- 2-B Remove Car Seat from Base**
- 2-C Attach Car Seat to Base**
- 2-D Choosing Vehicle Seat Location**
- 2-E Which Installation Method Should I Use?**

Rear-Facing Use

Pages 14-30

- 3-A Rear-Facing Checklist**
- 3-B Install With Base With Lower Anchor Attachment**
- 3-C Install With Base With Vehicle Seat Belt**

Vehicle Information

Pages 31-35

- 4-A How to Remove Lower Anchor Attachment**
- 4-B Unsafe Vehicle Seats**
- 4-C Vehicle Seat Belts**

Care & Cleaning

Page 35

- 5-A Cleaning Harness and Lower Anchor Attachment**



1 Important

1-A Welcome to the Graco Family!

This base is compatible ONLY with the Graco® GoMax™ car seat.

Your child's safety depends on you. **No car seat can guarantee protection from injury in every situation, but proper use helps reduce the risk of serious injury or death. READ THIS MANUAL CAREFULLY.**

This child restraint system conforms to all applicable Federal motor vehicle safety standards.

Even if this car seat seems easy to figure out on your own, you must follow the detailed instructions in this instruction manual to ensure the steps are performed correctly.

If You Need Help

In the U.S.A, please contact our Customer Service Department with any questions you may have concerning parts, use, or maintenance. When you contact us, please have your product's model number and date of manufacture ready so that we may help you efficiently. These numbers can be found on a sticker on the back side of your car seat.

Contact us at **www.gracobaby.com or call 1-800-345-4109.**

For additional resources or to get your car seat checked by a child passenger safety technician, please visit the following web sites:

www.nhtsa.gov • www.seatcheck.org • www.safekids.org

Register This Child Restraint



1 Important

Please fill out the prepaid registration postcard attached to the harness and mail it in today **or register online at www.gracobaby.com/carseatregistration**.

Child restraints could be recalled for safety reasons. You must register this restraint to be reached in a recall. Send your name, address, and the restraint's model number and manufacturing date to:

Graco Children's Products, Inc.
Attn: Customer Service
P.O. Box 169, Elverson, PA 19520-9901
or call 1-800-345-4109
or register online at
www.gracobaby.com/carseatregistration

For recall information, call the U.S. Government's Vehicle Safety Hotline at 1-888-327-4236 (TTY: 1-800-424-9153), or go to <http://www.NHTSA.gov>.

For future reference or if you change addresses, record the model name, model number, date of manufacture, and purchase date of this car seat below. You can find this information either on the registration card if you still have it or on the date label located on the back of the car seat.

Model Name _____

Model Number _____

Date of Manufacture _____

Date of Purchase _____

1-B Safety Warnings

! WARNING!

Failure to follow these instructions and child restraint's labels can result in child striking the vehicle's interior during a sudden stop or crash.

! According to accident statistics, children are safer when properly restrained in the rear seating positions than in the front seating positions. The center of the back



seat can be the safest during a possible side impact.



! NEVER place this child restraint rear-facing in a vehicle seating location that has an active front air bag.

If an air bag inflates, it can hit the child and car seat with great force and cause serious injury or death to your child.

- ! Review your vehicle owner's manual for more information about air bags and car seat use.**
- ! If your vehicle does not have a back seat, review your vehicle owner's manual.**
- ! Children are safer riding rear-facing and should ride rear-facing as long as possible, until they reach the maximum rear-facing height or weight rating for their car seat. Graco convertible and all-in-one car seats**



have higher rear-facing limits that will allow children to ride rear-facing longer after outgrowing their infant car seat. Be sure to check your local and state laws, as well as AAP and NHTSA recommendations, for car seat usage.*

- ! Select a suitable location for the car seat in your vehicle.**
- ! Secure car seat with a vehicle seat belt or lower anchor attachment that is properly routed as shown in this manual.**
- ! Vehicle seat belt system MUST hold car seat securely. Not all vehicle seat belts can be used with a car seat.**
- ! If vehicle seat belt does not hold car seat securely, read “Vehicle Seat Belts” section 4-C and your vehicle owner’s manual.**
- ! Always secure car seat with lower anchor attachment or a vehicle seat belt, even when unoccupied. In a crash, an unsecured car seat can injure passengers.**
- ! DO NOT use car seat if it is damaged or missing parts.**
- ! If car seat is in a crash, it must be replaced. DO NOT use it again! A crash can cause unseen damage and using it again could result in serious injury or death.**

*Graco Supports the American Academy of Pediatrics and National Highway Traffic Safety Administration’s Car Seat Guidelines. Visit www.gracobaby.com/en-US/safety for information on car seat usage recommendations.

! DO NOT use accessories or parts other than those provided by Graco except for a thin towel or mat to protect your vehicle seat or rolled towels or pool noodles to help get your car seat level. Their use could alter the performance of the car seat.

! DO NOT remove lower anchor attachment system from car seat. If using vehicle seat belt to secure car seat, lower anchor attachment connectors must be stored.

! Never leave child unattended, even when sleeping. Child may become tangled in harness straps and suffocate or strangle.

! Rear-facing car seat must be properly leveled:

- Too reclined can result in injury or ejection.
- Too upright can result in breathing difficulties.



! Never attach two lower anchor attachment connectors to one vehicle lower anchor point unless specifically allowed by the vehicle manufacturer.

! Do not use both the vehicle seat belt and lower anchor attachment strap at the same time when using the car seat rear-facing.

Car Seat's Useful Life

STOP using this car seat and throw it away 7 years after the date of manufacture. Look for date of manufacture label on back of the car seat.

Graco Children's Products Inc. advises against loaning or passing along a car seat unless you know the complete history of the product. We also advise against purchasing a car seat second hand.

1-C Aircraft Installation



This child restraint's **base** is NOT certified for use in aircraft.

Contact the airline for their specific policies.



1 Important

2-A Car Seat Features

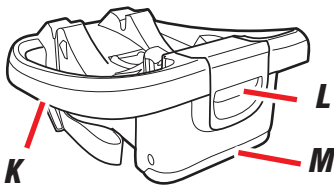
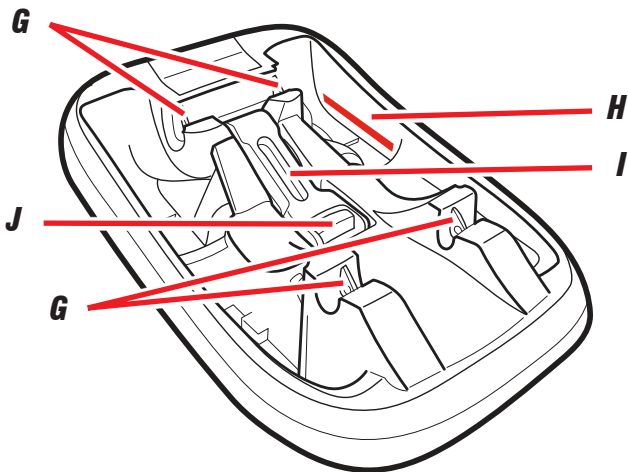

- G** Car Seat Base Lock
- H** Level Line
- I** SnugLock® Lock-Off
- J** SnugLock® Lock-Off Release Lever
- K** Lower Anchor Attachment Storage
- L** Base Recline Lever
- M** Base Recline Foot

2-B Remove Car Seat from Base

To Remove Car Seat from Base

From the back of the car seat, squeeze the release lever and lift the car seat out of the base.

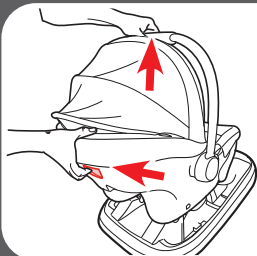

2-C Attach Car Seat to Base

Attaching Car Seat To Base

Align the locking bar at the front and rear of the car seat with the locks in the base. Set car seat in the base. Push down on the the car seat. You will hear a “click” when it is locked.

Pull up on the front and rear corners of the seat to make sure it is locked.

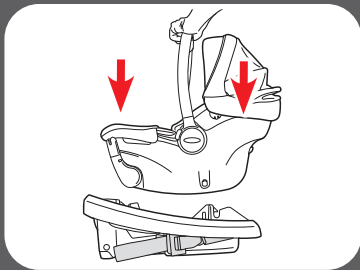
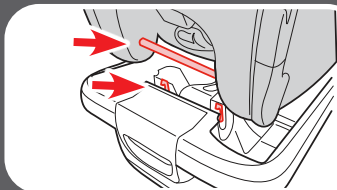

2-D Choosing Vehicle Seat Location

Review your vehicle owner's manual for seating locations. Review section 4 for additional information.

Some vehicles have specific requirements for where the car seat can be installed. Be sure to check your vehicle owner's manual for all available seating positions.

2 Features

⚠ WARNING!



NEVER place this child restraint rear-facing in a vehicle seating location that has an active front air bag.

In the event there is no back seat, review your vehicle owner's manual to see how to use your infant child restraint.

2-E Which Installation Method Should I Use?

This car seat can be installed in your vehicle using either the vehicle seat belt OR the lower anchor attachment system. Both systems are equally safe to use. **DO NOT USE BOTH AT THE SAME TIME.**

The lower anchor attachment system allows you to securely attach your car seat in your car without using the vehicle seat belt and possibly to get a better fit. All 2003 and newer model year vehicles are required to have a lower anchor attachment system, although some manufacturers began including lower anchor attachment earlier. Some vehicle owner manuals use the term ISOFIX to identify the lower anchor attachment system.

Review your vehicle's owner manual for exact location and use. Review section 4 for additional information.

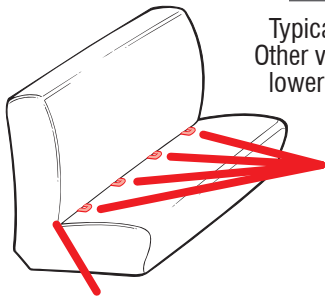

Vehicle Seat Crease

Typical seat in a passenger vehicle. Other vehicle types may have different lower anchor attachment locations.

Vehicle Lower Anchor

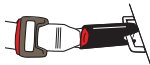

3-A Rear-Facing Checklist

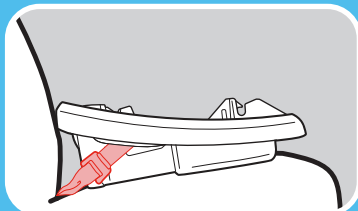

Lower Anchor Attachment

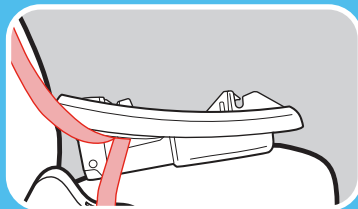

Vehicle Lap/Shoulder Seat Belt

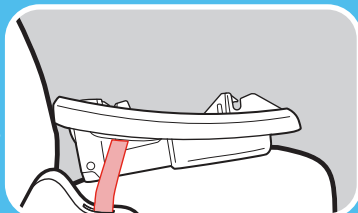

Vehicle Lap Only Seat Belt

Rear-Facing:

- Car seat **MUST** be rear-facing in the vehicle back seat.
- Make sure lower anchor attachment strap or vehicle seat belt is routed through the rear-facing belt path, marked with a blue label.
- Install this car seat tightly in your vehicle. When installed with the Lower Anchor Attachment or the vehicle seat belt, the car seat **should not move** at the belt path more than 1" (2.5 cm) from side to side and front to back.
- Make sure to check the level line for proper recline.
- Make sure base is a minimum of 80% on vehicle seat.



3 Rear Facing

Children are safer riding rear-facing and should ride rear-facing as long as possible, until they reach the maximum rear-facing height or weight rating for their car seat. Graco convertible and all-in-one car seats have higher rear-facing limits that will allow children to ride rear-facing longer after outgrowing their infant car seat. Be sure to check your local and state laws, as well as AAP and NHTSA recommendations, for car seat usage.



3-B Install With Base With Lower Anchor Attachment

Review your vehicle owner's manual for lower anchor attachment location and use.

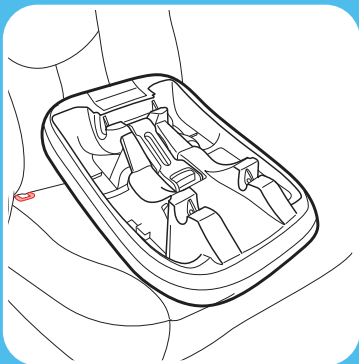

1. Place Base in Back Seat of the Vehicle

Place the base flat on the vehicle seat. Push it back until the front of the base touches the vehicle seat back. Center the base between the lower anchor attachment lower anchor attachment anchors.

If allowed by your Vehicle Owner's Manual, the center seating position may be used if the anchor spacing is 11" (28 cm) or greater.



3 Rear Facing

2. Remove the Lower Anchor Attachment Connectors from Storage Location

Unhook the lower anchor attachment connectors and remove from storage position.

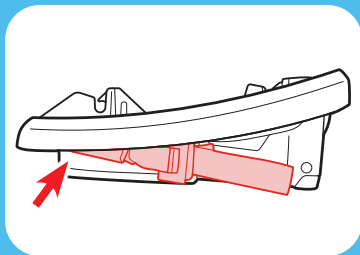

3. Open the SnugLock® Lock-Off

Push in the release lever and open the lock-off.

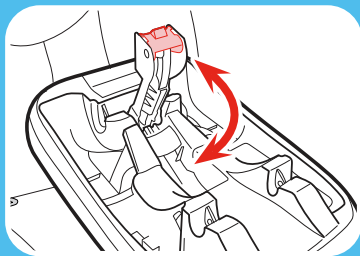
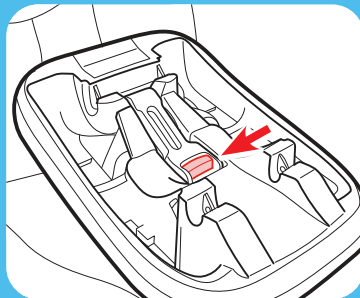

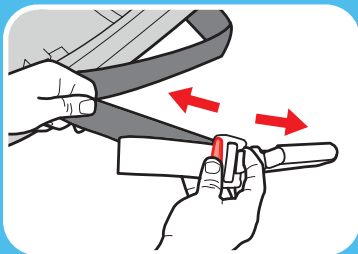

4. **Extend the Lower Anchor Attachment Strap**

Extend the lower anchor attachment strap to its maximum length by pressing the gray button and pulling on the strap.

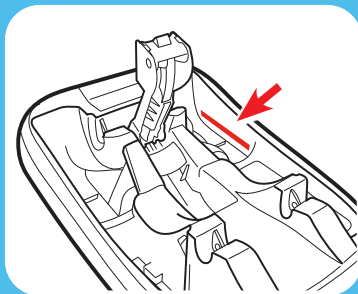

5. **Check the Level Line**

The red level line on the side of the base **MUST BE LEVEL** with the ground.

Once the seat is installed, make sure the bubble on the level indicator is completely within the blue lines.

Readjust the recline if needed.

6. Recline the base

If the red level line is not level with the ground, you **MUST** adjust the recline position.

To adjust the recline, squeeze the base recline lever on the front of the base and lift or lower the base to the appropriate recline.

Recheck the level line.

When the foot is completely extended and the level line is not level to the ground, you may raise the foot and place a rolled towel or pool noodle under the foot until the line is level to the ground.

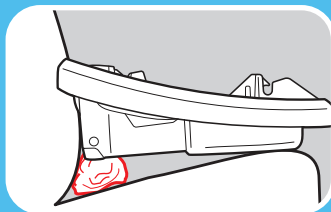
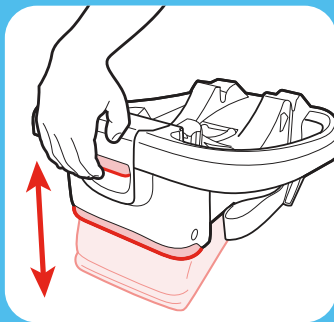

3 Rear
Facing

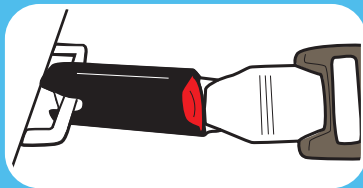

7. Connect Lower Anchor Attachment Connectors to Vehicle's Lower Anchor Attachment Anchors

Lower anchor attachment strap should lay as flat as possible and not be twisted.

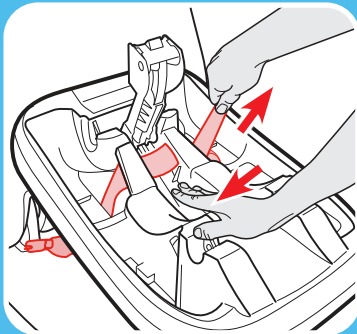

8. Remove the Slack

Press down firmly on the top of the base while pulling on the free end of the lower anchor attachment strap to remove all the slack.

Do not pull on the strap with excessive force.

9. Close the SnugLock® Lock-Off

Shut the lock-off on top of the lower anchor attachment strap.

Close the lock-off until you hear a “Click”.

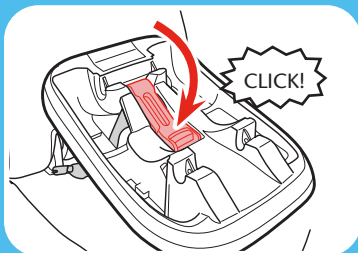

!WARNING!

Keep hands away from the lock-off area when closing the lock-off.

10. Test For Tightness

Grab the sides of the base at the belt path, push and pull the base from side to side and front to back.

If the base moves less than 1" (2.5 cm), it is tight enough.

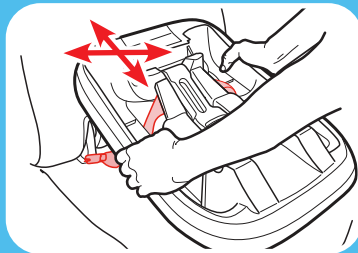

3 Rear Facing



**3 Rear
Facing**

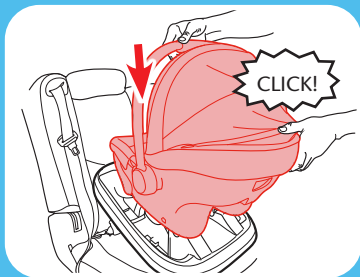

11. Attach Car Seat to Base

Place car seat into the base. Push down on the front and rear of the car seat and handle until you hear a “click”.

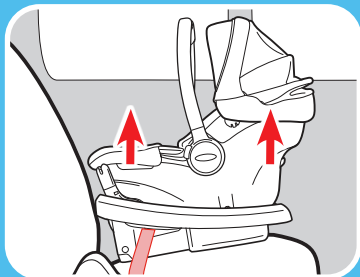

Test to make sure the car seat is attached by pulling up on the front and rear corners of car seat.

12. Check the Level Indicator

Vehicle **MUST** be on level ground.

Check the level indicator with child in the child restraint.

- Place the bubble completely within the blue lines to ensure the seat is level.
- For a more reclined position place the bubble in the light blue line.
- For more upright seating, the bubble can be partially or completely in the dark blue line.
- If the bubble is not completely under the blue lines, the child restraint is NOT level. You must adjust your recline position.

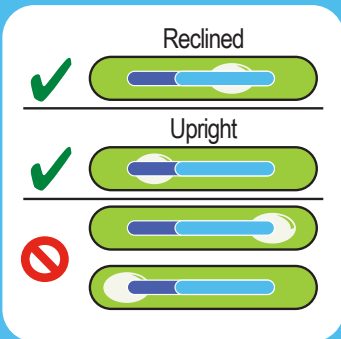
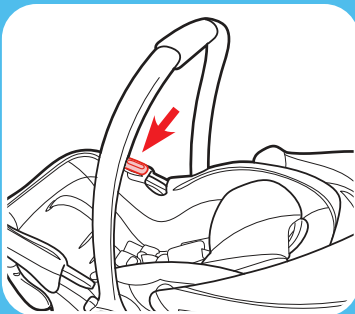

3 Rear Facing

3-C Install With Base With Vehicle Seat Belt

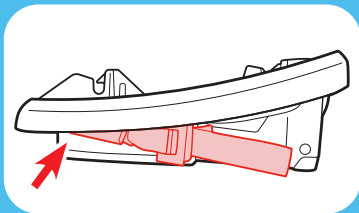

1. **Store Lower Anchor Attachment Connectors**

Attach the lower anchor attachment connectors to the plastic bars on sides of base as shown. Remove the slack.

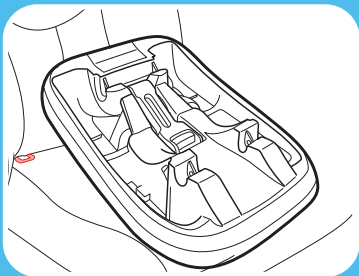

2. **Place Base in Back Seat of the Vehicle**

Place the base flat on the vehicle seat. Push it back until the front of the base touches the vehicle seat back.



3 Rear
Facing

3. Open the SnugLock® Lock-Off

Push in the release lever and open the lock-off.

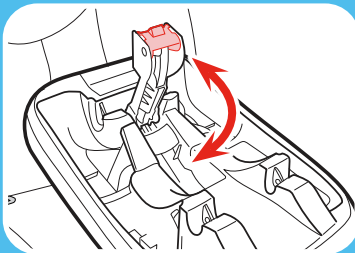
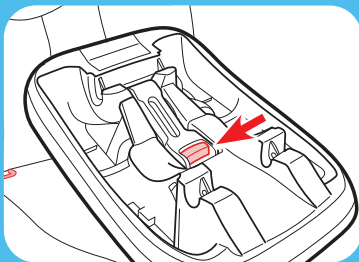

4. Check the Level Line

The red level line on the side of the base **MUST BE LEVEL** with the ground.

Once the seat is installed, make sure the bubble on the level indicator is completely within the blue lines.

Readjust the recline if needed.

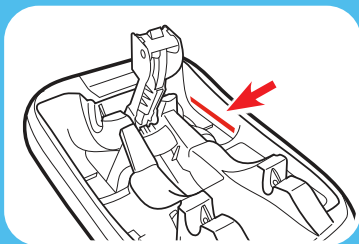

3 Rear
Facing

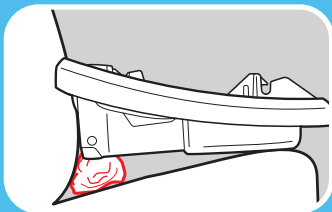
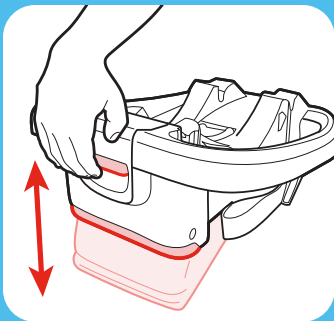

5. Recline the base

If the red level line is not level with the ground, you **MUST** adjust the recline position.

To adjust the recline, squeeze the base recline lever on the front of the base and lift or lower the base to the appropriate recline.

Recheck the level line.

When the foot is completely extended and the level line is not level to the ground, you may raise the foot and place a rolled towel or pool noodle under the foot until the line is level to the ground.

6. Route the Vehicle Seat Belt

Thread the vehicle seat belt through the rear-facing belt path (marked with a blue label) and buckle it. The seat belt should lay as flat as possible and not be twisted.

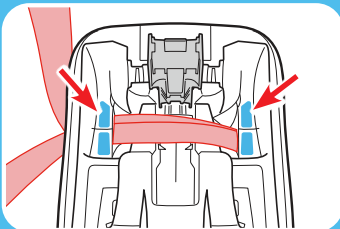
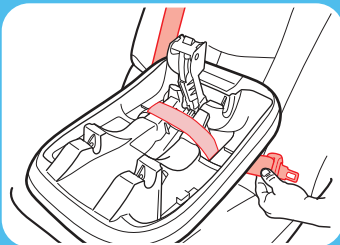

Review your vehicle's owner's manual for vehicle seat belt use

7. Tighten the Vehicle Seat Belt

Press down firmly on the top of the base while pulling on the shoulder belt to remove the slack.

Do not pull on the strap with excessive force.

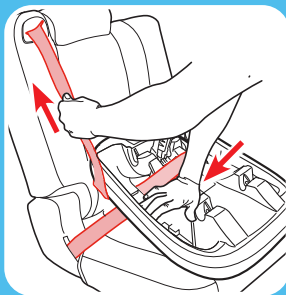

27



3 Rear Facing

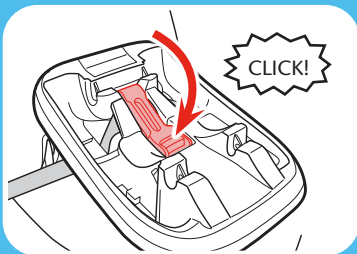

**8. Close the SnugLock®
Lock-Off**

Push down on the arm until the you hear a click.

⚠ WARNING!

Keep hands away from the lock-off area when closing the lock-off.



**3 Rear
Facing**

9. Test For Tightness

Grab the sides of the base where the seat belt is and push and pull the base from side to side and front to back.

If the base moves less than 1" (2.5 cm), it is tight enough.

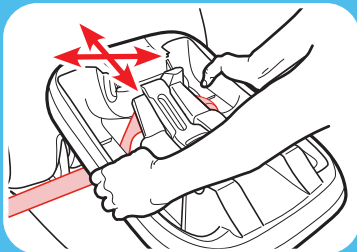

10. Attach Car Seat to Base

Place car seat into the base. Push down on the front and rear of the car seat and handle until you hear a "click".

Test to make sure the car seat is attached by pulling up on the front and rear corners of car seat.

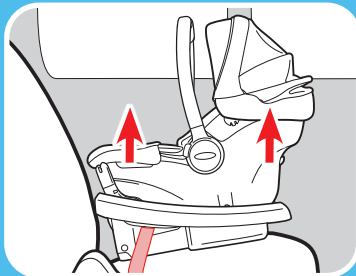
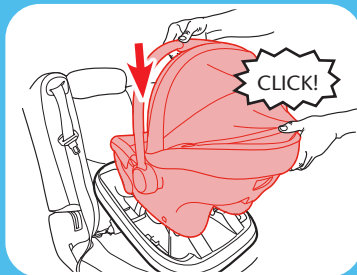

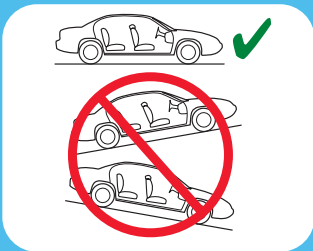
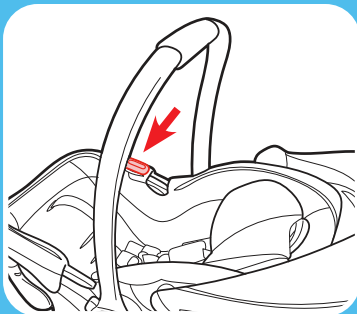

Reclined



Upright



11. Check the Level Indicator

Vehicle **MUST** be on level ground.

Check the level indicator with child in the child restraint.

- Place the bubble completely within the blue lines to ensure the seat is level.
- For a more reclined position place the bubble in the light blue line.
- For more upright seating, the bubble can be partially or completely in the dark blue line.

- If the bubble is not completely under the blue lines, the child restraint is **NOT** level. You must adjust your recline position.

4-A How to Remove Lower Anchor Attachment

1. Push Button In While Pulling on Lower Anchor Attachment Strap to Loosen

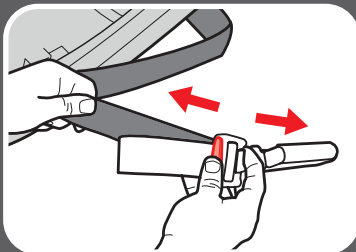

2. Press the Lower Anchor Attachment Release Button



3. Pull Away From Anchor Point

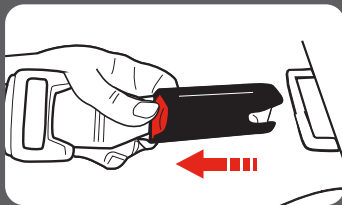

4-B Unsafe Vehicle Seats

Never install this car seat in side-facing or rear-facing vehicle seats.



4-C Vehicle Seat Belts

Review your vehicle owner's manual for vehicle seat belt use

This car seat can be installed using a vehicle seat belt. To do this, you will need to change the seat belt to a locked mode for use with car seats. With some vehicle seat belts, this is done with the latch plate; with other vehicle seat belts, this is done with the retractor.

Vehicle Seat Belt Terms

Retractor

A device that winds up the unused vehicle seat belt. It is often hidden inside the panels on the walls of the vehicle or in the vehicle seat back.

Latch Plate

The male end of the seat belt with the silver tongue.

Seat Crease

The crease where the vehicle seat back and seat bottom meet.

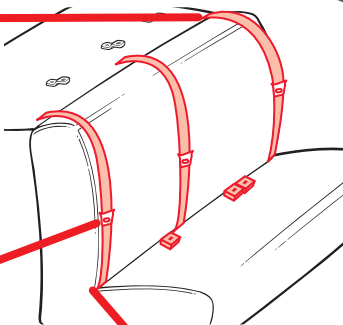

Identify Your Seat Belt Type

There are two different types of vehicle seat belts that can be used with this car seat:

Lap/Shoulder Seat Belt

3 connection points.

Lap Only Seat Belt

2 connection points.

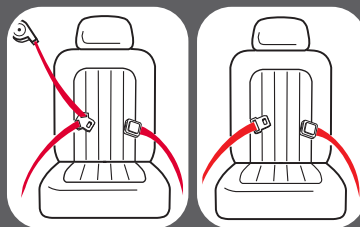

33

The following types of vehicle seat belts **CANNOT** be used safely with this car seat:



Lap Belt with Motorized
Shoulder Belt



Lap Belt or Shoulder Belt
Mounted on Door

Belts Forward of the
Seat Crease

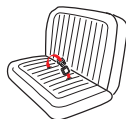

Some vehicles you may
not get a secure fit.
Read both your vehicle
and car seat manuals.

Lap/Shoulder Seat Belt Installation

Always review your vehicle owner's manual for specific information about your vehicle seat belts.

Most vehicles manufactured after 1996 will have Switchable retractors in the back seat. If you have any questions about your retractor type, consult your vehicle owner's manual, call Graco or visit www.gracobaby.com/vehicle-seatbelt-information.

To verify you have a Switchable retractor, **slowly** pull the belt all the way out, and then allow it to retract several inches. Try to pull the belt all the way out again. If it cannot be pulled out, it is **Switchable** retractor. Follow the steps in the rear-facing sections in this manual.

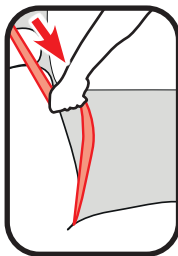

5-A Cleaning Harness and Lower Anchor Attachment

Surface wash only with mild soap and damp cloth. **DO NOT IMMERSE THE HARNESS STRAPS or LOWER ANCHOR ATTACHMENT STRAP IN WATER.** Doing so may weaken the straps.

If harness straps or lower anchor attachment strap are frayed or heavily soiled, contact Customer Service at www.gracobaby.com or 1-800-345-4109.

Replacement Parts

To purchase parts or accessories in the United States,
please contact us at the following:

www.gracobaby.com

or

1-800-345-4109