



# INFLATABLE CANOES & KAYAKS

Including the following Model Series:  
Colorado™, Big Basin™ and Fiji™.

## READ THE FOLLOWING INSTRUCTIONS AND WARNINGS TO AVOID DROWNING OR SERIOUS INJURY

### **WARNING**

Failure to follow these warnings could cause **SEVERE INJURY** or **DEATH**.

- **CONSULT WITH A PHYSICIAN** prior to beginning paddle sport training. Paddle sports can be very dangerous and physically demanding.
- **OBTAIN PADDLESPORT TRAINING** specific to this type of craft. Do not exceed your padding ability - be honest with yourself. Obtain certified first aid training and carry first aid and safety/rescue equipment.
- **WEAR U.S. COAST GUARD APPROVED LIFE JACKETS**, and where appropriate, wear a helmet.
- **NOT A LIFE SAVING DEVICE.**
- **NEVER PADDLE ALONE.**
- **CHECK WEATHER FORECAST BEFORE DEPARTING DOCK** and heed all weather advisories.
  - **DRESS APPROPRIATELY** for the weather conditions, as cold water and/or cold weather can cause hypothermia.
  - **DO NOT PADDLE IN FLOOD CONDITIONS.**
- **BE AWARE OF THE WATER CONDITIONS**, including appropriate water levels, tidal changes, dangerous currents and other water hazards. Do not use in high wind, strong currents, open water or dangerous tides. Always scout unfamiliar waters, and portage where appropriate.
- **NEVER PADDLE WHILE UNDER THE INFLUENCE** of drugs or alcohol.
- **KEEP PROPER LOOKOUT AND SAFE DISTANCE** from other vessels and hazards at all times.
- **OBEY APPLICABLE BOATING LAWS.** Know and follow local water safety rules and boating regulations.
- **READ THE OWNER'S MANUAL** and follow the manufacturer's recommendations for the use this product. It is the owner's responsibility to carefully read the manual and instruct all users in safe operation of this product. Consult the manufacturer's information prior to adding aftermarket equipment.
- **DO NOT OVERLOAD OR OVERINFLATE.** Adults should inflate the chambers in numbered sequence.



## IMPORTANT INFORMATION

The warnings below relate to various situations. Please observe them.

### ⚠ CAUTION!

Denotes an imminent hazard which will result in severe injury if you do not comply with the instructions.

### ⚠ WARNING!

Reminds you of safety measures which must be observed. Also denotes unsafe practices which could result in personal injury or damage to the product or property, if you do not comply with the instructions.

### ⚠ CAUTION!

**It is the owner's responsibility to make sure all users carefully read and follow the instructions for safe operation of this product. Observe all local and national laws. Always wear a Personal Flotation Device approved by the proper authorities. Please carefully observe the Capacity Plate information which is printed on the product.**

### ⚠ WARNING!

These products are not meant for towing because the extreme pressure of the water while towing can tear the eyelets and/or handles.

These products are made of the highest quality materials and comply with NMMA (National Marine Manufacturers Association) regulations.

### ⚠ CAUTION!

Altering the construction of these products could jeopardize the safety of the occupants and will void the limited warranty.

### ⚠ CAUTION!

**Do not over inflate. Pressurize product to "Inflation Pressure" stated in the chart for your specific product.**

### ⚠ WARNING!

Never use a compressor, CO<sub>2</sub> or compressed air to inflate the product. Do not let your product come into contact with sharp, pointed objects.

### ⚠ CAUTION!

Keep product away from gasoline, battery acid, solvents, etc., as they can damage the product.

<b>IF FOUND - CONTACT</b> <b>SI SE ENCUENTRA - COMUNICARSE CON</b> <b>EN CAS DE DÉCOUVERTE - CONTACTEZ</b>
Name/Nombre/Nom: _____
Phone/Teléfono/Téléphone: _____
Phone/Teléfono/Téléphone: _____

Please complete the “if found label” located on the boat with the boat owners contact information in large print with a permanent marker.

### INFLATION INSTRUCTIONS

To inflate using any Sevylor® Pump:

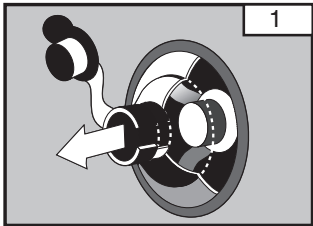

1. To begin inflation, open external cap and pull firmly on the lanyard to extend out. This will open internal yellow seal.

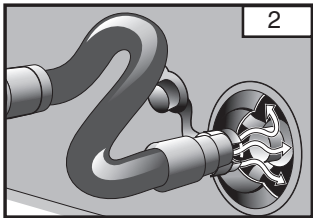

2. Attach nozzle of hose to inflation end of pump. Insert adapter nozzle into valve and start pumping.

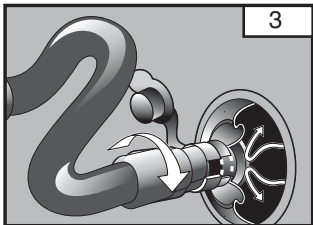

3. When fully inflated, seal valve by pushing in with adapter nozzle. This will seal the internal yellow stopper and keep air from escaping while closing cap. Gently twist adapter while backing hose out of valve.

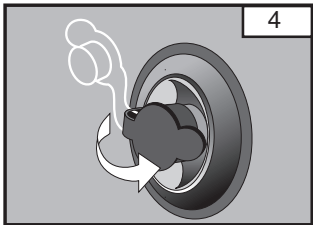

4. Fully remove pump and hose and close external cap. Valve should appear depressed into itself.

**To inflate using any Sevylor® Pump for Boston Valve:**

**Boston Valve** is a two-way valve consisting of two parts: the valve insert (center portion) and the square cap on top. To inflate through a Boston valve screw-in the center portion (the end with longer threads) into the valve-base on the bladder and then attach the pump nozzle to it; to deflate unscrew the valve insert (center portion). The square cap with rubber gasket makes the valve air tight once it is screwed onto the valve insert.

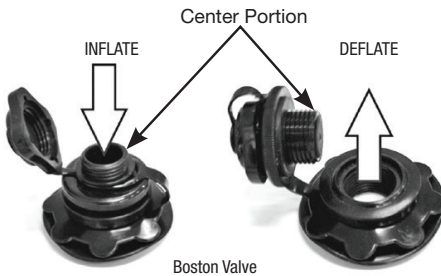

**IMPORTANT!** Inflate the product chambers in the following order:

1. Inflate the floor chamber(s).
2. Inflate the outside main chamber(s).

The chambers on the product will also be numbered to indicate order of inflation also. This order of inflation will ensure the proper volume and buoyancy of the safety chamber.

**Note:** To inflate the mini Double Lock™ valve, which is used on some of the Sevylor® product floors and seat bottoms, follow the same inflation instructions above or previous instructions, using the mini Double Lock™ valve adapter. The mini Double Lock™ valve adapter is included with all Sevylor® pumps. The adapter can be purchased from Sevylor Customer Service by calling 1-800-835-3278 US | 1-800-387-6161 CA (Part Number 5010000707).

**⚠ CAUTION!**

Water temperature and weather does affect the pressure in inflatable products. In cold weather your product will lose some pressure due to the fact the air will contract. If this occurs, you may want to add a little air to improve your products performance. However, in hot weather, the air will expand. You must let some air out to prevent your product from failing due to overpressure. You should avoid exposing your product to extreme temperatures (hot or cold).

**DEFLATION INSTRUCTIONS**

**Deflation instructions using any Sevylor® Pump:**

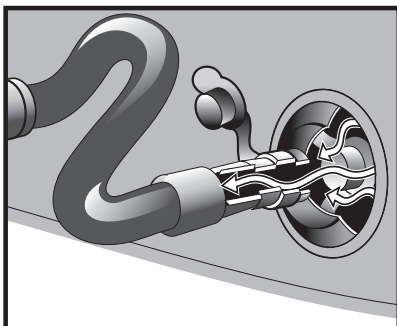

Remove nozzle of hose from inflation end and attach to opposite deflation end of pump. Repeat same steps as inflation. This will draw the air out quickly.

Your product is NMMA certified using the ABYC standard.



sevylor INFLATABLE CANOES & KAYAKS

**⚠ WARNING!**

**Do not exceed the certified maximum capacities under any circumstances!**

NMMA (ABYC Standard)	Persons Capacity	Maximum Payload Capacity	Inflation Pressure	Inflation Pressure
Model #	Persons Only	Persons, Gear	Main Chamber(s)	Floor Chamber(s)
Fiji™ Kayak	2 Pers. or 380 lbs.	400 lbs.	0.9 PSI	0.9 PSI

**⚠ WARNING!**

**Do not attempt to mount a motor on any boat does not state a Max. HP engine rating.**

NMMA (ABYC Standard)	Persons Capacity	Maximum Payload Capacity	Engine	Inflation Pressure	Inflation Pressure
Model #	Persons Only	Persons, Gear, Motor (if applicable)	Max. HP Engine	Main Chamber(s)	Floor Chamber(s)
Colorado™ 2 Person HF	2 Pers. or 440 lbs.	500 lbs.	12V Electric Motor Sevylor 2000004144	1.5 PSI	1.5 PSI

**⚠ WARNING!**

**Do not exceed the certified maximum capacities under any circumstances!**

NMMA (ABYC Standard)	Persons Capacity	Maximum Payload Capacity	Inflation Pressure	Inflation Pressure
Model #	Persons Only	Persons, Gear	Main Chamber(s)	Floor Chamber(s)
Big Basin™ 3 Person	3 Pers. or 490 lbs.	490 lbs.	1.5 PSI	1.5 PSI

## OPERATING INSTRUCTIONS:

- Follow all local boating regulations and navigation rules. Familiarize yourself with boating conditions where you plan to use the boat. Use common sense and caution when operating in unfamiliar places.
- Observe the maximum weight the product can carry and do not overload past this limit. Over-loading jeopardizes the safety of the occupants.
- Be sure all accessories and/or equipment (e.g. oars, life jackets) are in proper working condition before using the boat. Each person occupying the boat is to wear an approved Personal Flotation Device (life preserver).
- Sharp objects are not to be carried in the product without adequate protection or storage.
- When navigating the product in any water depth, watch for submerged or sharp objects that may damage or pierce the boat's air chambers.
- Enter the product from the port (left) or starboard (right) sides - not from the fore (front) or aft (back) sides.
- Never tow with a boat or any other vehicle.

### MOTOR MOUNTING

#### ⚠ WARNING!

**ROTATING PROPELLER MAY CAUSE SERIOUS INJURY OR DEATH**  
 •Keep away from the rear of boat while engine is running.

#### ⚠ WARNING!

**Do not attempt to mount a motor on any boat does not state a Max. HP engine rating.**

### CARE & STORAGE:

- These products are made of the highest quality materials and comply with NMMA (National Marine Manufacturers Association) regulations. Altering the construction of these products will void the limited warranty and could jeopardize the safety of the occupants.
- If your product has been used in salt water, rinse it off with fresh water as soon as possible.
- Remove tar spots or other soiled areas by using a mild soap and rinsing with fresh water.
- Be sure your product is completely dry before storing.
- The products may be stored inflated, but do not place any heavy or sharp objects on it. Storage is best in a dry room.

## REPAIRING SMALL PUNCTURES

Inadvertent punctures can be repaired using 2 different methods described below.

**Included “Sticky Back Repair Patch”** (included with select models only)

1. Thoroughly clean and dry the damaged area. Completely deflate the product.
2. Cut a portion of the patch to cover the puncture and allow an additional ¼” on all sides. Always cut a round patch, never leave square corners.
3. Be sure the repair area is completely dry.
4. Peel the backing from the patch.
5. Adhere the patch to the puncture.
6. Using your thumb or finger, apply even pressure across the entire surface of the patch.

**Included Vinyl Repair Patch** (included with select models only)

If your model does not include the Sticky Repair Patch noted above, then it will come with a Vinyl Repair Patch. This vinyl repair patch does not include vinyl glue, but it can be purchased from any home or hardware store (PVC cement).

1. Thoroughly clean and dry the damaged area. Completely deflate the product.
2. Cut a portion of the patch to cover the puncture and allow an additional ¼” on all sides. Always cut a round patch, never leave square corners.
3. Be sure the repair area is completely dry.
4. Apply generous coat glue to the vinyl repair patch and to the product.
5. Allow the glue to dry for 2 to 3 minutes, or until the glue becomes tacky.
6. Apply the patch to the product, using your thumb or finger; apply even pressure across the entire surface of the patch. Make sure the edges of the patch are pressed down along the entire diameter.
7. Allow the product to dry for at least 10 hours before inflating and using.

### Fiji™

**2 PERSON**

2 Spray Covers

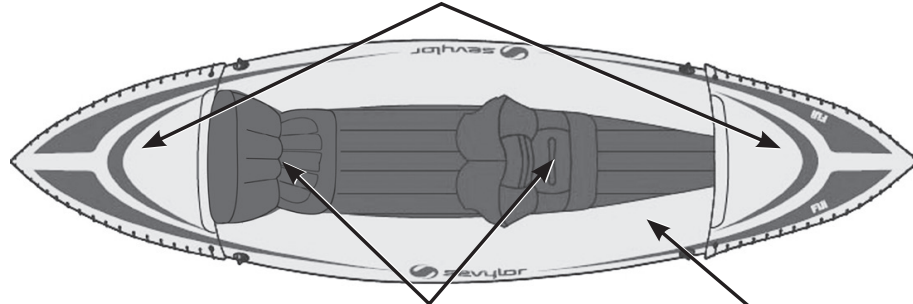

Two Seats (One Removable)

Two Main Chambers with Tubular I-beam Floor

### Colorado™

**2 PERSON FH For 2P only**

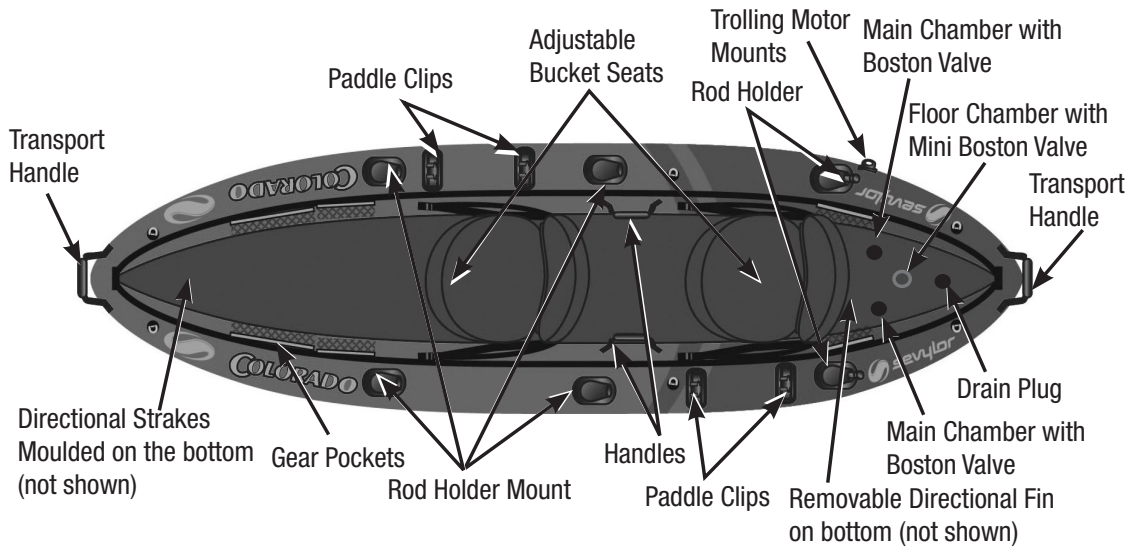

### BIG BASIN™

**3 PERSON**

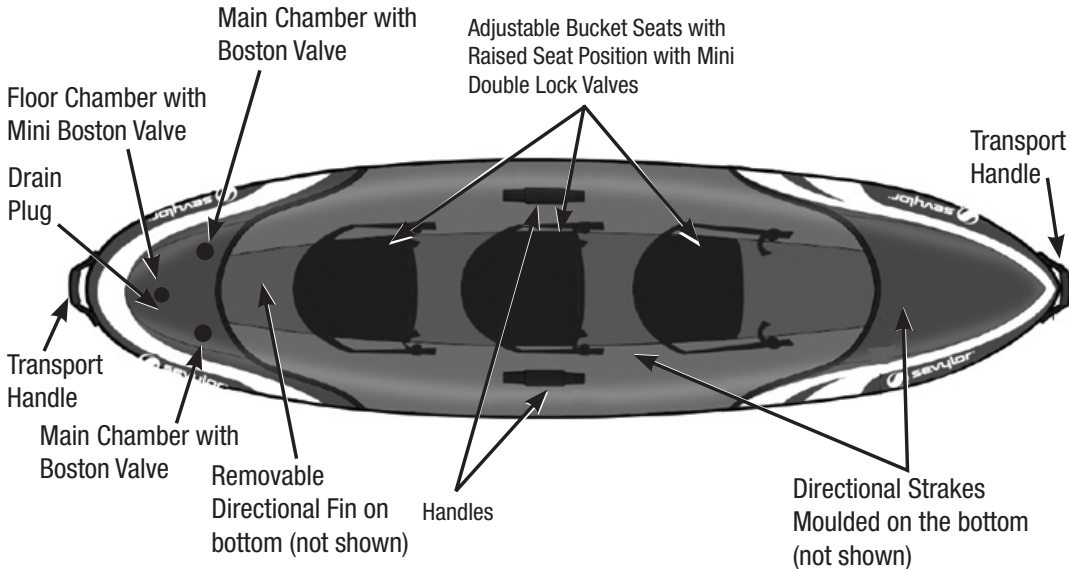



## PADDLE ASSEMBLY: SELECT MODELS ONLY.

Join the three shafts together by screwing them together with the two couplers. Attach the blade to the shafts by screwing onto the end of the shaft.

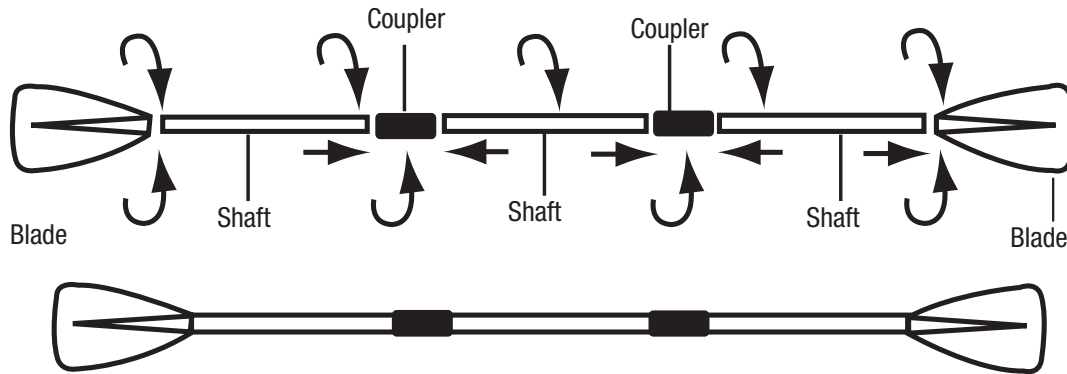

## GUIDELINES FOR USAGE:

These kayaks may be wider than a typical kayak, which means they may feel more stable. However, as with any narrow, flat bottom kayak, users must be aware of the possibility of the kayak tipping and compensate for it. Paddle with short, even and easy strokes. Paddle close to the kayak with the paddle almost vertical. Pull with one hand and push with the other. If the nose of the kayak is moving right to left you are probably paddling too hard. Ease off on the force of your stroke to reduce the swaying of the front end. Paddling backward or breaking can sometimes offer quick maneuverability.

## PRODUCT WARRANTY:

See the 90 days and 1 year limited warranty pages for details.

- Products without a fabric covered hull have a limited 90 day warranty. Models as follows: Fiji Kayak Series.
- Products with a fabric covered hull have a limited 1 year warranty. Models as follows: Colorado Kayak Series & Big Basin Kayak Series.

## 90 Days Limited Warranty

The Coleman Company, Inc. ("Coleman") warrants that for a period of 90 days from the date of original retail purchase, this product will be free from defects in material and workmanship. Coleman, at its option, will repair or replace, free of charge, this product or any component of the product found to be defective during the warranty period. Replacement will be made with a new or remanufactured product or component at no cost to the consumer. If the product is no longer available, replacement may be made with a similar product of equal or greater value. This is your exclusive warranty.

This warranty is valid for the original retail purchaser from the date of initial retail purchase and is not transferable. Keep the original sales receipt. Proof of purchase is required to obtain warranty performance. Coleman dealers, service centers, or retail stores selling Sevylor® products do not have the right to alter, modify or in any way change the terms and conditions of this warranty.

### What This Warranty Does Not Cover

This warranty does not cover normal wear of parts, parts that are not genuine Sevylor® parts, or damage resulting from any of the following: negligent use or misuse of the product; commercial use of the product; use contrary to the operating instructions; disassembly, repair or alteration by anyone other than Coleman or an authorized service center. Coleman expressly excludes from this warranty and denies liability for defects or damage caused by repair or alteration by anyone other than Coleman. Further, the warranty does not cover Acts of God, such as fire, flood, hurricanes and tornadoes. Warranty void if damage to product results from the use of a part other than a genuine Sevylor® part.

No terms of this warranty may be construed to apply to non-warranty service and maintenance. Accordingly, Coleman also denies liability for defects and damage caused by the use of unauthorized parts, repair, service or alteration outside the terms of this warranty.

**COLEMAN SHALL NOT BE LIABLE FOR DEFECTS THAT ARE CAUSED BY THE USE OF UNAUTHORIZED PARTS OR SERVICE. COLEMAN SHALL NOT BE LIABLE FOR ANY INCIDENTAL OR CONSEQUENTIAL DAMAGES CAUSED BY THE BREACH OF ANY EXPRESS OR IMPLIED WARRANTY OR CONDITIONS. EXCEPT TO THE EXTENT PROHIBITED BY APPLICABLE LAW, ANY IMPLIED WARRANTY OF MERCHANTABILITY OR FITNESS FOR A PARTICULAR PURPOSE IS LIMITED IN DURATION TO THE DURATION OF THE ABOVE WARRANTY OR CONDITIONS. SOME STATES, PROVINCES, OR JURISDICTIONS DO NOT ALLOW THE EXCLUSION OR LIMITATION OF INCIDENTAL OR CONSEQUENTIAL DAMAGES OR LIMITATIONS ON HOW LONG AN IMPLIED WARRANTY LASTS, SO THE ABOVE LIMITATIONS OR EXCLUSION MAY NOT APPLY TO YOU. THIS WARRANTY GIVES YOU SPECIFIC LEGAL RIGHTS, AND YOU MAY ALSO HAVE OTHER RIGHTS THAT VARY FROM STATE TO STATE OR PROVINCE TO PROVINCE.**

### How to Obtain Warranty Service

Take the product to an authorized Coleman service center. You can find the nearest authorized Coleman service center by visiting [www.coleman.com](http://www.coleman.com) or calling 1-800-835-3278 or TDD 1-316-832-8707 in the United States or 1-800-387-6161 in Canada. If a service center is not conveniently located, attach to the product a tag that includes your name, address, daytime telephone number and description of the problem. Include a copy of the original sales receipt. **Carefully package the product and send either by courier or insured mail with shipping and insurance prepaid to:**

**For products purchased in the United States:**

The Coleman Company, Inc.  
3600 North Hydraulic  
Wichita, KS 67219 U.S.A.

**For products purchased in Canada:**

Newell Brands Canada ULC  
20B Hereford Street  
Brampton, ON L6Y 0M1

The costs of transporting the product to Coleman or an authorized service center for warranty service is the responsibility of the purchaser.

**DO NOT RETURN THIS PRODUCT TO THE PLACE OF PURCHASE.**

If you have any questions regarding this warranty please call 1-800-835-3278 or TDD 1-316-832-8707 in the United States or 1-800-387-6161 in Canada.

## 1 Year Limited Warranty

The Coleman Company, Inc. ("Coleman") warrants that for a period of 1 year from the date of original retail purchase, this product will be free from defects in material and workmanship. Coleman, at its option, will repair or replace, free of charge, this product or any component of the product found to be defective during the warranty period. Replacement will be made with a new or remanufactured product or component at no cost to the consumer. If the product is no longer available, replacement may be made with a similar product of equal or greater value. This is your exclusive warranty.

This warranty is valid for the original retail purchaser from the date of initial retail purchase and is not transferable. Keep the original sales receipt. Proof of purchase is required to obtain warranty performance. Coleman dealers, service centers, or retail stores selling Sevylor® products do not have the right to alter, modify or in any way change the terms and conditions of this warranty.

### What This Warranty Does Not Cover

This warranty does not cover normal wear of parts, parts that are not genuine Sevylor® parts, or damage resulting from any of the following: negligent use or misuse of the product; commercial use of the product; use contrary to the operating instructions; disassembly, repair or alteration by anyone other than Coleman or an authorized service center. Coleman expressly excludes from this warranty and denies liability for defects or damage caused by repair or alteration by anyone other than Coleman. Further, the warranty does not cover Acts of God, such as fire, flood, hurricanes and tornadoes. Warranty void if damage to product results from the use of a part other than a genuine Sevylor® part.

No terms of this warranty may be construed to apply to non-warranty service and maintenance. Accordingly, Coleman also denies liability for defects and damage caused by the use of unauthorized parts, repair, service or alteration outside the terms of this warranty.

**COLEMAN SHALL NOT BE LIABLE FOR DEFECTS THAT ARE CAUSED BY THE USE OF UNAUTHORIZED PARTS OR SERVICE. COLEMAN SHALL NOT BE LIABLE FOR ANY INCIDENTAL OR CONSEQUENTIAL DAMAGES CAUSED BY THE BREACH OF ANY EXPRESS OR IMPLIED WARRANTY OR CONDITIONS. EXCEPT TO THE EXTENT PROHIBITED BY APPLICABLE LAW, ANY IMPLIED WARRANTY OF MERCHANTABILITY OR FITNESS FOR A PARTICULAR PURPOSE IS LIMITED IN DURATION TO THE DURATION OF THE ABOVE WARRANTY OR CONDITIONS. SOME STATES, PROVINCES, OR JURISDICTIONS DO NOT ALLOW THE EXCLUSION OR LIMITATION OF INCIDENTAL OR CONSEQUENTIAL DAMAGES OR LIMITATIONS ON HOW LONG AN IMPLIED WARRANTY LASTS, SO THE ABOVE LIMITATIONS OR EXCLUSION MAY NOT APPLY TO YOU. THIS WARRANTY GIVES YOU SPECIFIC LEGAL RIGHTS, AND YOU MAY ALSO HAVE OTHER RIGHTS THAT VARY FROM STATE TO STATE OR PROVINCE TO PROVINCE.**

### How to Obtain Warranty Service

Take the product to an authorized Coleman service center. You can find the nearest authorized Coleman service center by visiting [www.coleman.com](http://www.coleman.com) or calling 1-800-835-3278 or TDD 1-316-832-8707 in the United States or 1-800-387-6161 in Canada. If a service center is not conveniently located, attach to the product a tag that includes your name, address, daytime telephone number and description of the problem. Include a copy of the original sales receipt.

**Carefully package the product and send either by courier or insured mail with shipping and insurance prepaid to:**

#### For products purchased in the United States:

The Coleman Company, Inc.  
3600 North Hydraulic  
Wichita, KS 67219 U.S.A.

#### For products purchased in Canada:

Newell Brands Canada ULC  
20B Hereford Street  
Brampton, ON L6Y 0M1

The costs of transporting the product to Coleman or an authorized service center for warranty service is the responsibility of the purchaser.

**DO NOT RETURN THIS PRODUCT TO THE PLACE OF PURCHASE.**

If you have any questions regarding this warranty please call 1-800-835-3278 or TDD 1-316-832-8707 in the United States or 1-800-387-6161 in Canada.

© 2023 The Coleman Company, Inc. All rights reserved.

Colorado™, Fiji™ and Big Basin™ are trademarks of The Coleman Company, Inc.

Sevylor® and  are registered trademarks of The Coleman Company, Inc.



3600 North Hydraulic • Wichita, KS 67219 U.S.A.

1-800-835-3278 US | 1-800-387-6161 CA

4010025813 (ECN0068604-D)